

POWERFLEX®

PART NUMBER

PFF32-802

DESCRIPTION

FRONT CONTROL ARM TO CHASSIS BUSH

INSTALLATION GUIDE

Contents (parts per pack):

- 4 x Polyurethane Bushes
- 1 x PTFE/Silicone Grease
- 2 x Stainless Steel Sleeves
- 2 x Zinc Plated Mild Steel Outer Shells

Please read the complete fitting instructions and check package components before fitment. These fitting instructions are to be used as a guide and in conjunction with workshop manual.

It is recommended that:

- all work to be carried out by a licensed technician;
- all safety precautions adhered to;
- wheel alignment to be checked and adjusted as required after any suspension work.
- All fasteners must be tensioned to manufacturer's torque settings.



Fitting Instructions:

1. Remove the original rubber bush from the front control arm.
2. Clean any dirt and corrosion from the bore of the arm and file off any sharp edges.
3. Insert the zinc plated mild steel outer shell into the bore of the arm, with the top lip facing the top of the arm, as shown in Figure 1.
4. Push the polyurethane bushes into the bore of the outer shell so they sit flush inside.
5. Apply some of the supplied grease into the bore of the polyurethane bush and insert the stainless steel sleeve into the bush so it sits flush inside.
6. Refit the arm back to the vehicle and tension all hardware to manufacturers recommended torque settings.

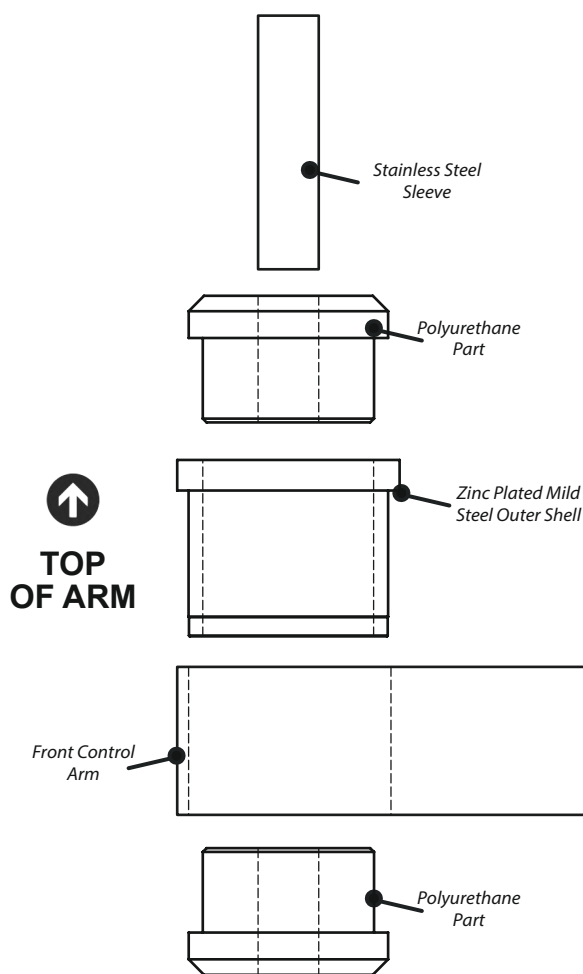

Figure 1